

- NOTES:**
1. All work shall be in accordance with the specifications of the City of San Bernardino.
 2. The curb shall be constructed with concrete and shall be finished with a broom finish.
 3. All obstructions marked "T" shall be removed under this contract.

ELM & PIPE 8451' & 8451' GARNER AVENUE ELEV. 530'

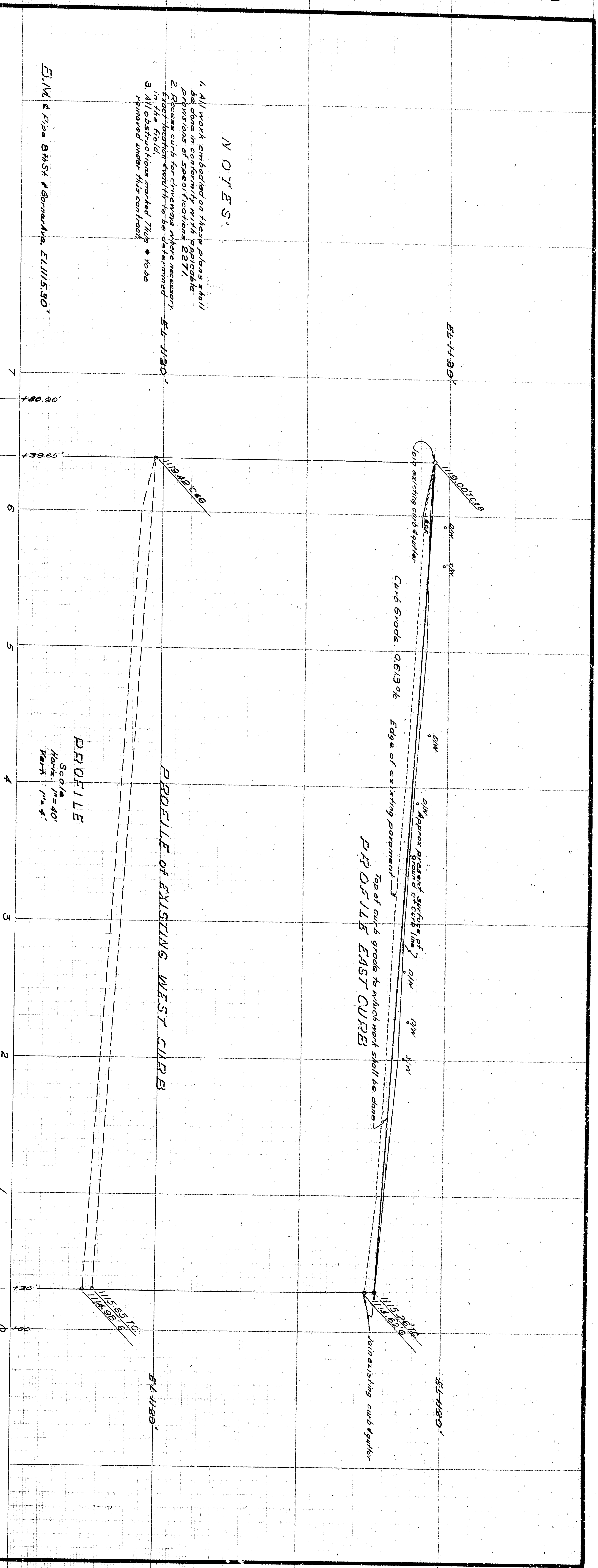

TYPICAL SECTION - R.C.C. CURB

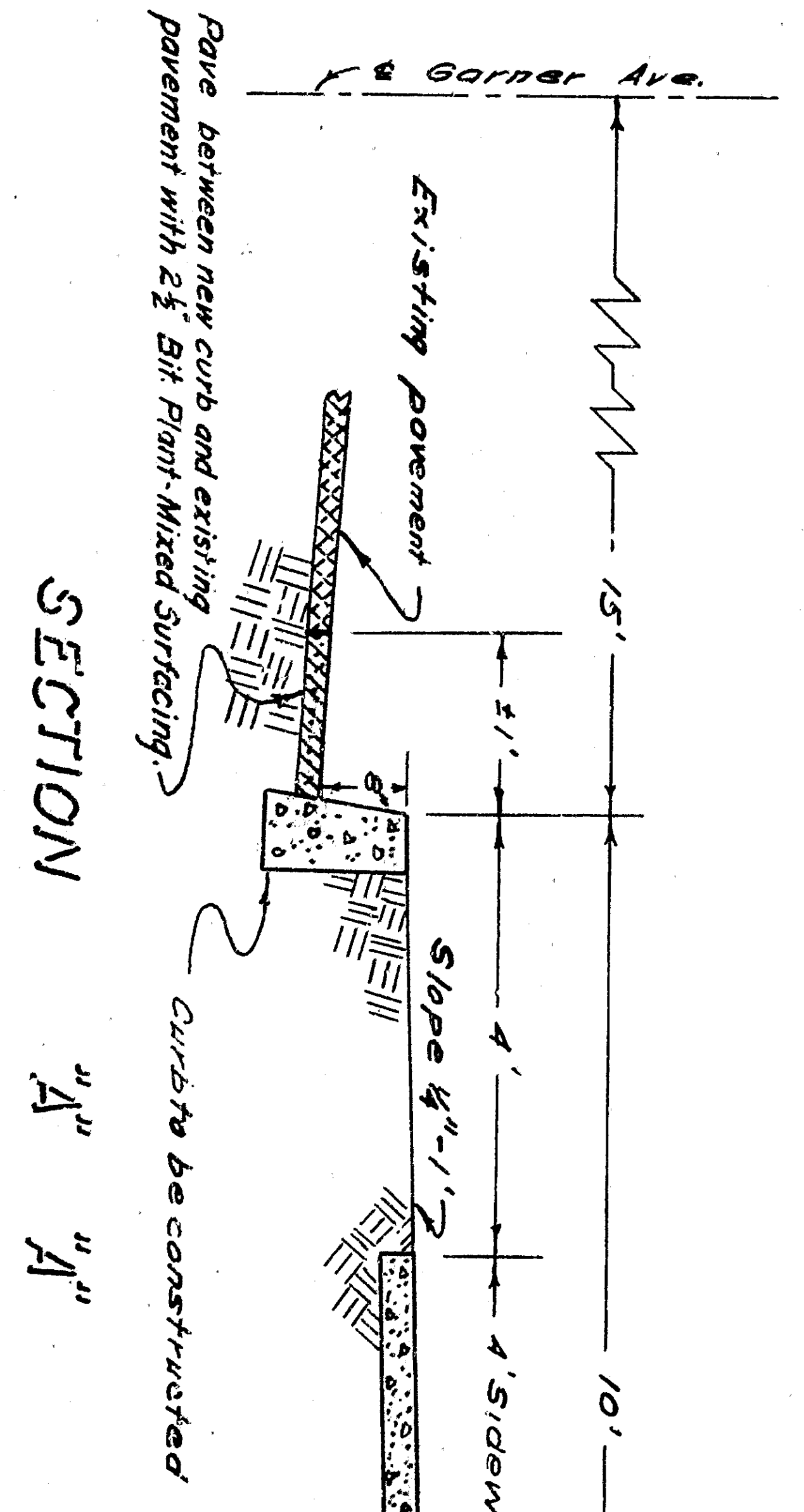
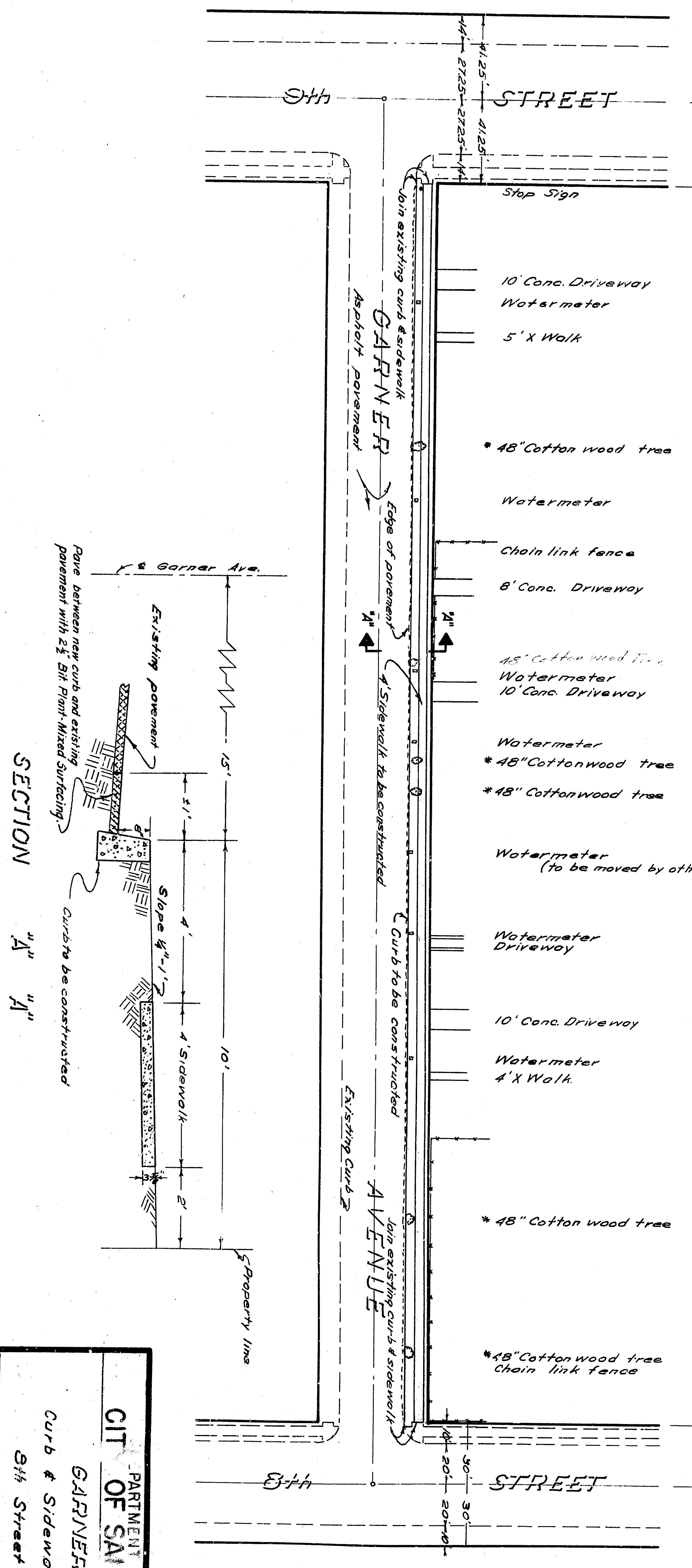
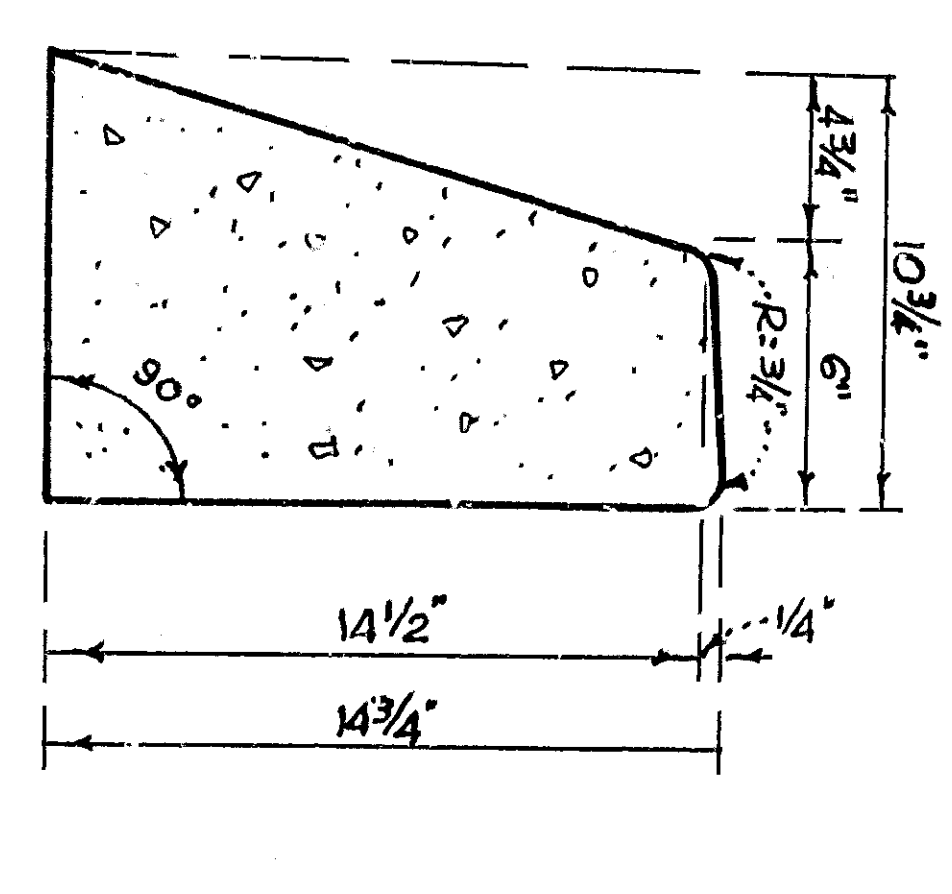

CIT PARTMENT ENGINEERING
OF SAN BERNARDINO

GARNER AVENUE
Curb & Sidewalk (East side only)

8th Street to 9th Street

DESIGNED BY: [Signature]
APPROVED BY: [Signature]
REGISTERED ENGINEER: [Signature]

DATE: Aug 1 58
SHEET: 2359
PROJECT: 2062

- NOTES:**
1. All work shall be in accordance with the specifications of the City of Denver.
 2. The curb shall be constructed with concrete and shall be finished with a broom texture.
 3. All obstructions marked "T.M." shall be removed under this contract.

ELM & PIPE 8451' & GARNERIA EL 1115.30'

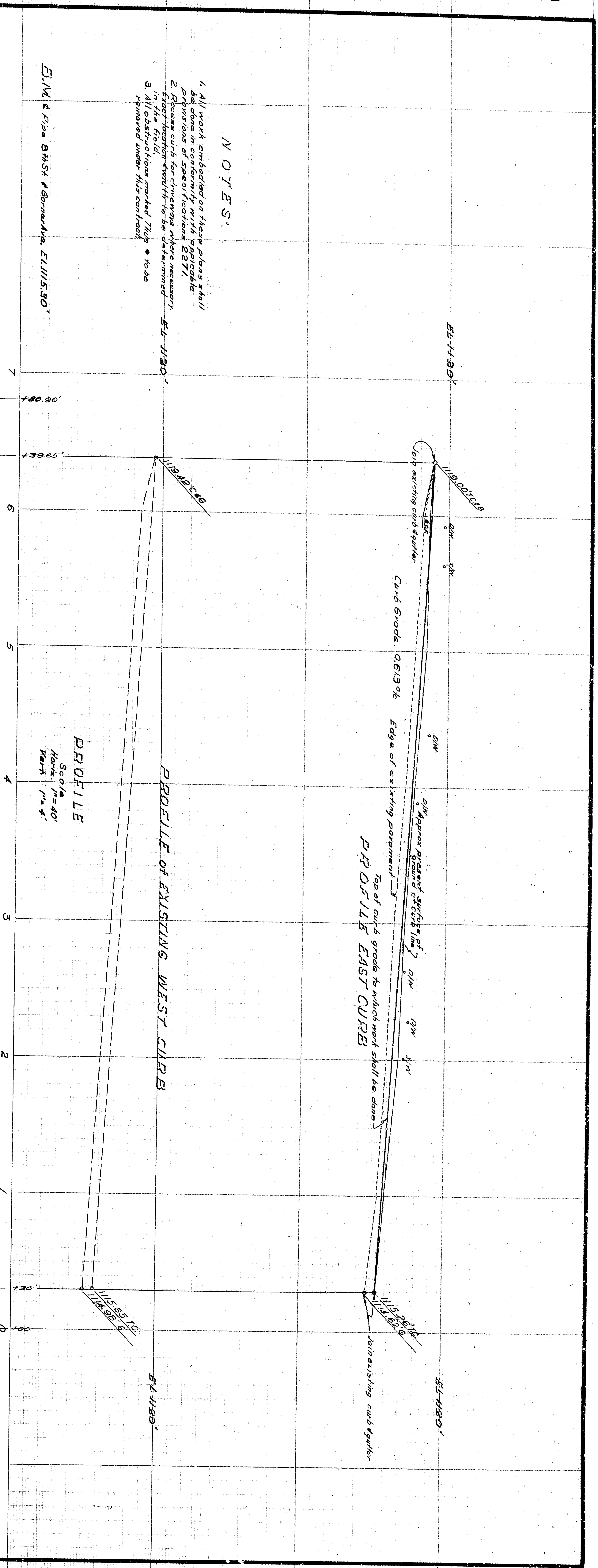

PLAN
Scale 1" = 40'

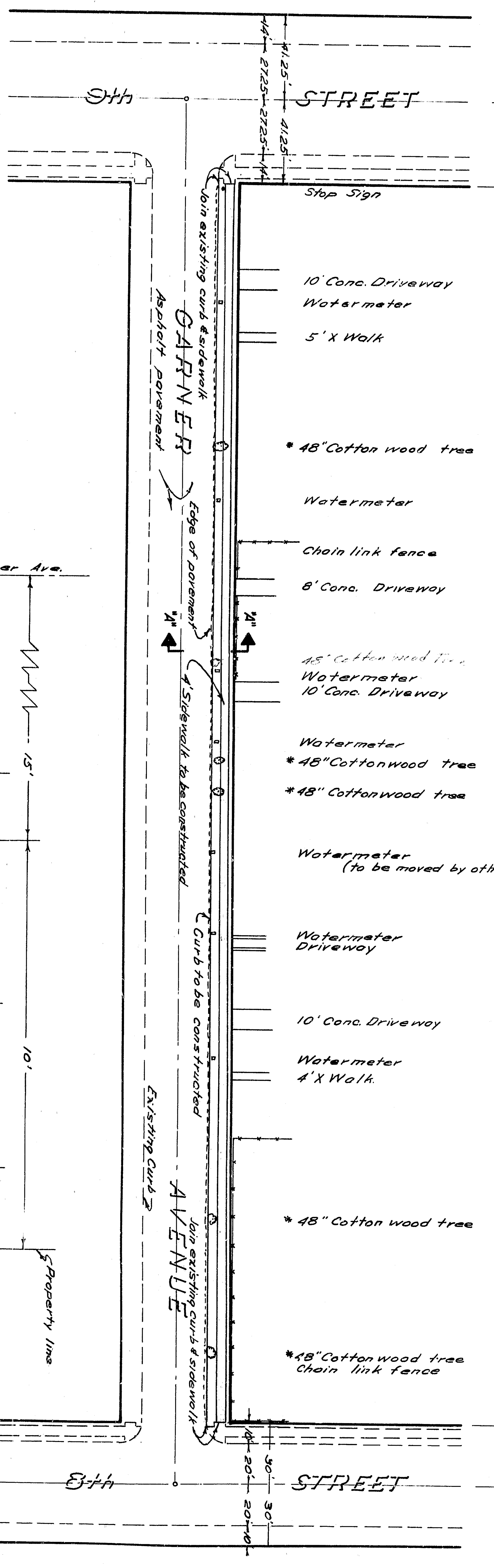

TYPICAL SECTION - R.C.C. CURB

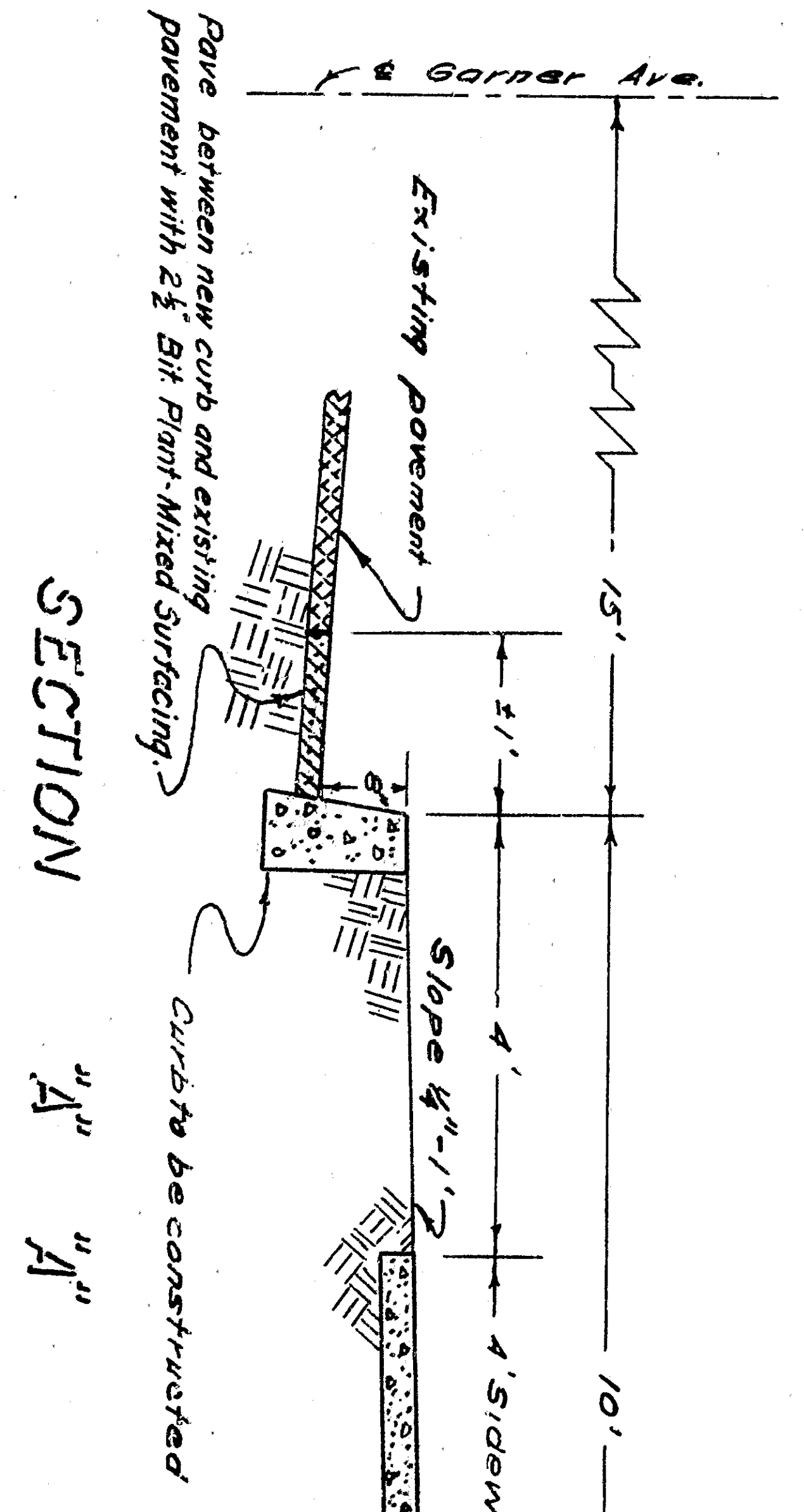
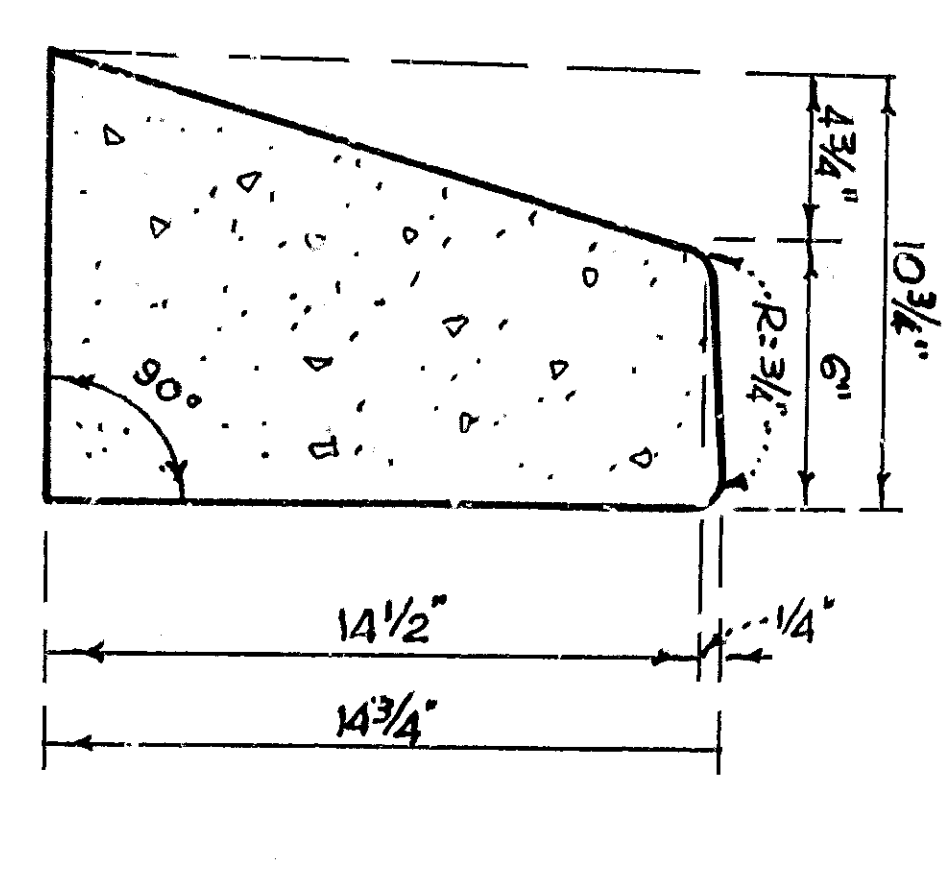

2-0-98

CIT PARTMENT ENGINEERING
OF SAN BERNARDINO

GARNER AVENUE
Curb & Sidewalk (East side only)
8th Street to 9th Street

DESIGNED BY: [Signature]
APPROVED BY: [Signature]
REGISTERED PROFESSIONAL ENGINEER
NO. 2062

DATE: Aug 1 58
SCALE: AS SHOWN
SHEET NO. 2359